

Schweighofer HUA Watering Design
(Landowner Amendments/Requests)

Install 3 main waterlines with separate shutoffs (located in the warm room) for the following:

- Waterers and frost free hydrants on the southwest side of building
- Waterers on the northeast side of building
- Hydrants on the northwest side of the building

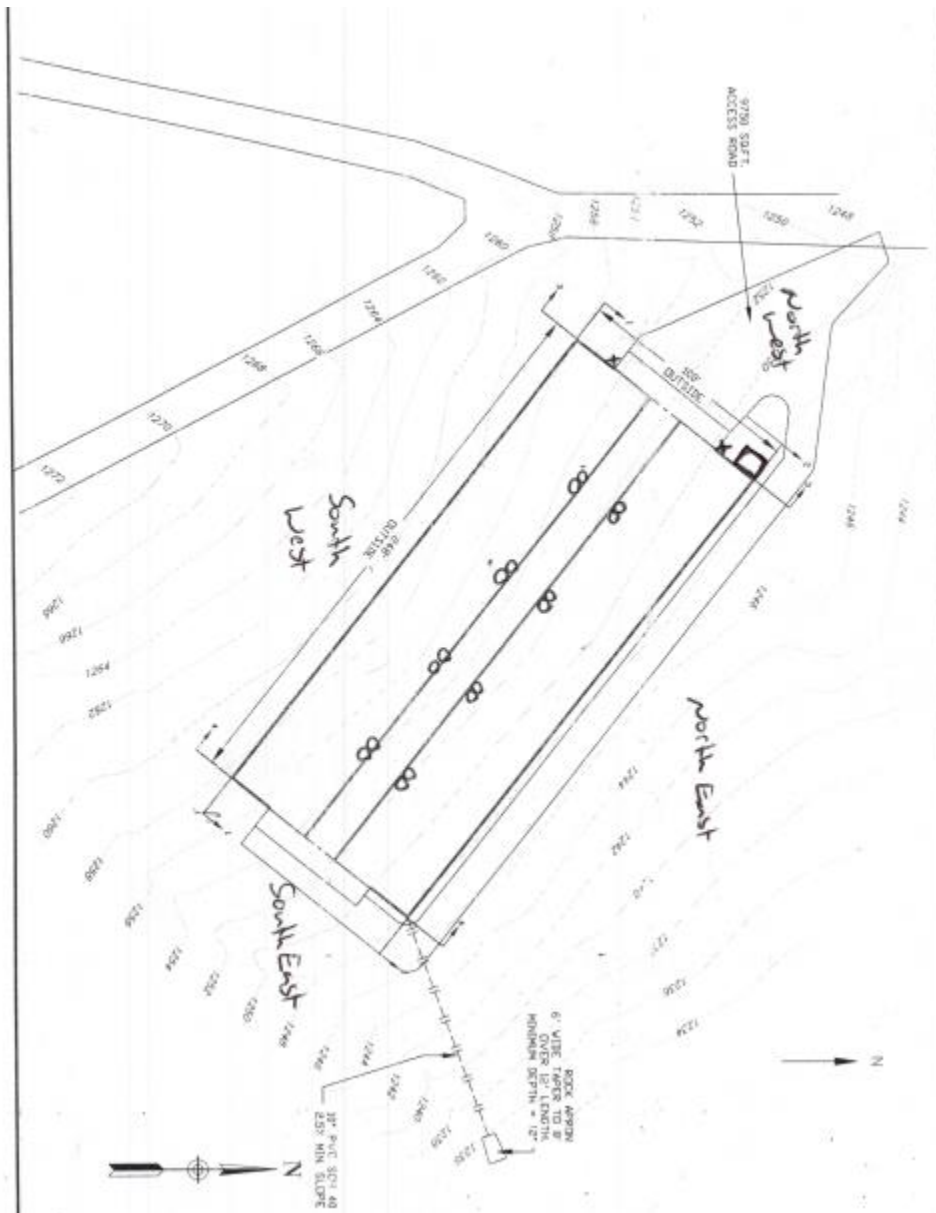

Starting on the road access side (Northwest), place thermal tubes for waterers on 48' centers to line up with center support posts. Placed on the animal side of the HUA (not center feed alley) 4 tubes per side, 8 total. Each thermal tube/waterer line should include an underground shutoff valve. On southwest side of building also place 4 frost free stand pipes. Wrap pipe before concrete installation to prevent binding

of standpipe to concrete. Standpipes should be located 1 foot off center of thermal tubes and 6 inches in from side of concrete pad. (See drawings for details.) Essentially stand pipes will start at 49' and continue on 48' centers. Make note: Concrete pads for waterers on either side of the feed alley will be slightly different in size because of the frost free hydrants on one side of HUA.

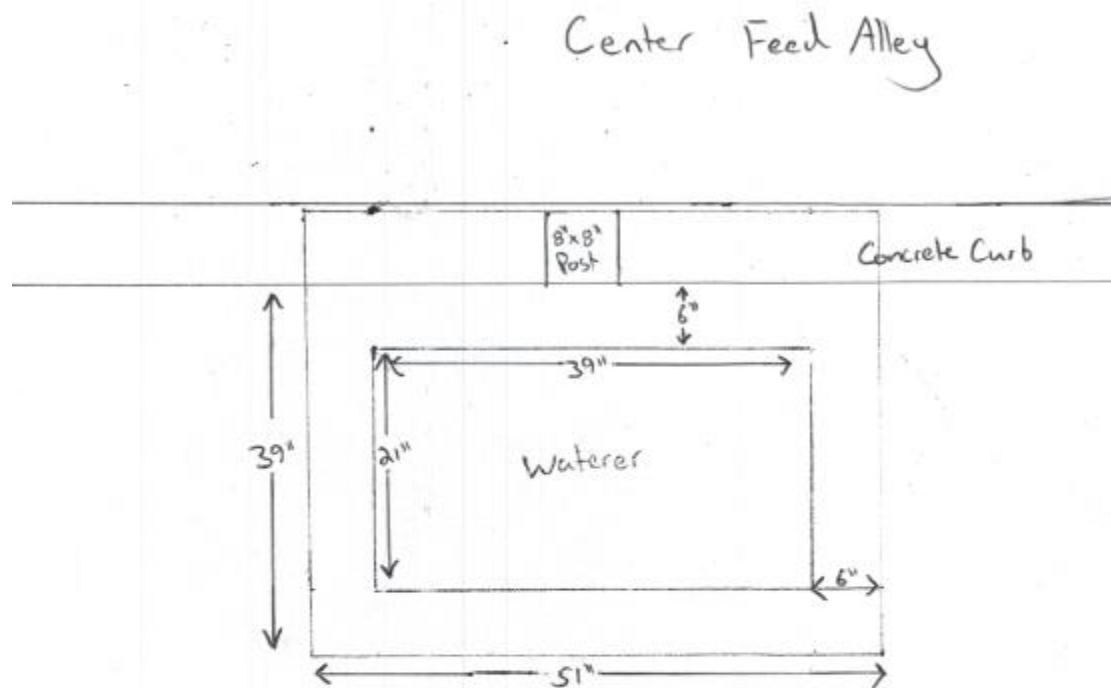

Northeast HUA

Center Feed Alley

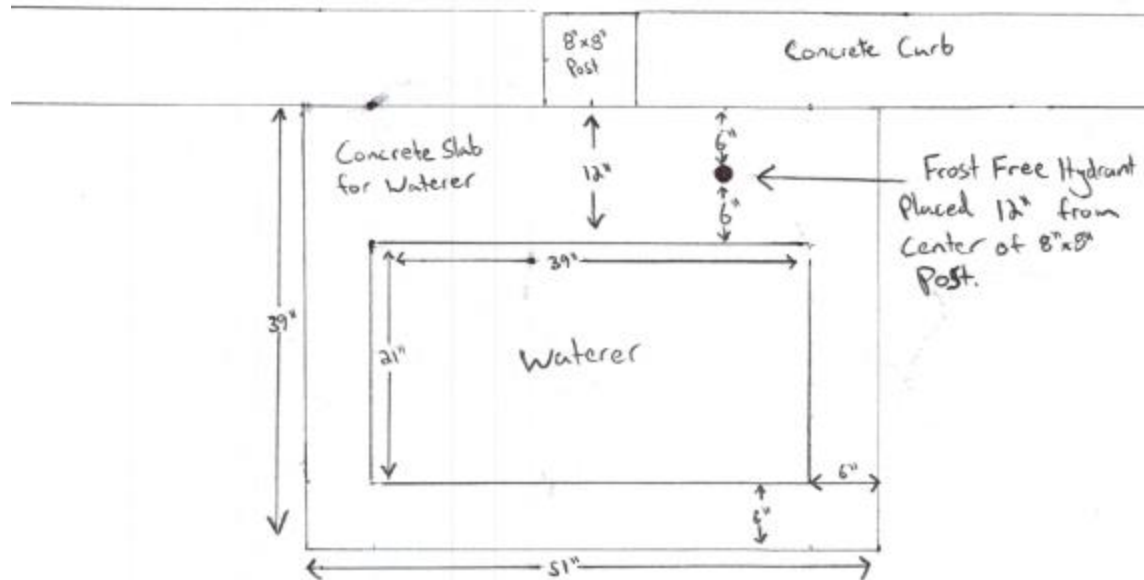

Southwest HUA.

2 frost free hydrants should be placed on the outside of the Northwest wall of the HUA. One to either side of each gateway into the HUA. See drawings.

The proposed 8'x8' insulated warm room is depicted in these drawings as well.